



PLM-II
1

PLM-II
2



MANUAL CHAIN HOIST | **PULLMASTER-II**

The manual chain hoist PLANETA – Pullmaster-II is our valued price alternative to many hoists on the market. It complies fully with all relevant. International standards and the CE-regulations for Europe. Its solid design and easy way of handling made him many friends through the last years. You will find Pullmaster-II in many kinds of industry, shipyards, on cranes and also for maintenance.

Safety brake

The large sized safety brake works instantly when operation is stopped, holding the load safely in any position.

Reliable material

The housings are made of steel, the hook holder and sheeves are of cast steel. This makes Pullmaster-II robust and sturdy.

Swivel hook

Top and bottom hook are out of tempered high tensile steel. They have spring loaded, galvanized safety latches with side bending protection.

Luxury rust protection

Screws, nuts, discs, washers, bolts, the complete middle section and the chains are galvanized to offer a reliable corrosion protection. All other steel parts are painted or powder-coated with our best blue finish. Top quality load chain accords to EN 818-7-T and shines zinc galvanized.

Option: With RFID chip for digital equipment testing. More on page 08.

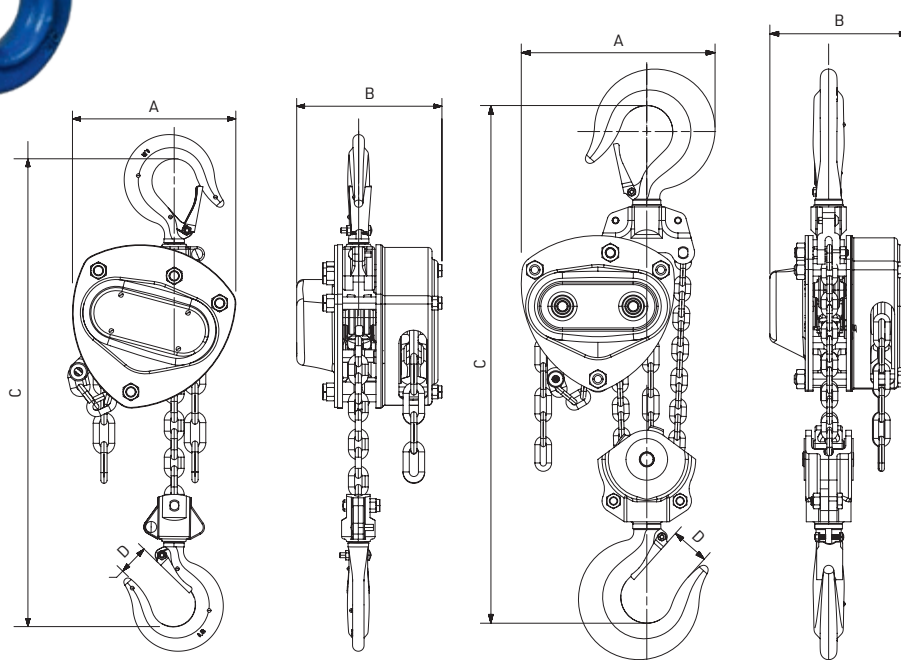

PULLMASTER-II 500-1,500 kg

PULLMASTER-II 2,000-5,000 kg

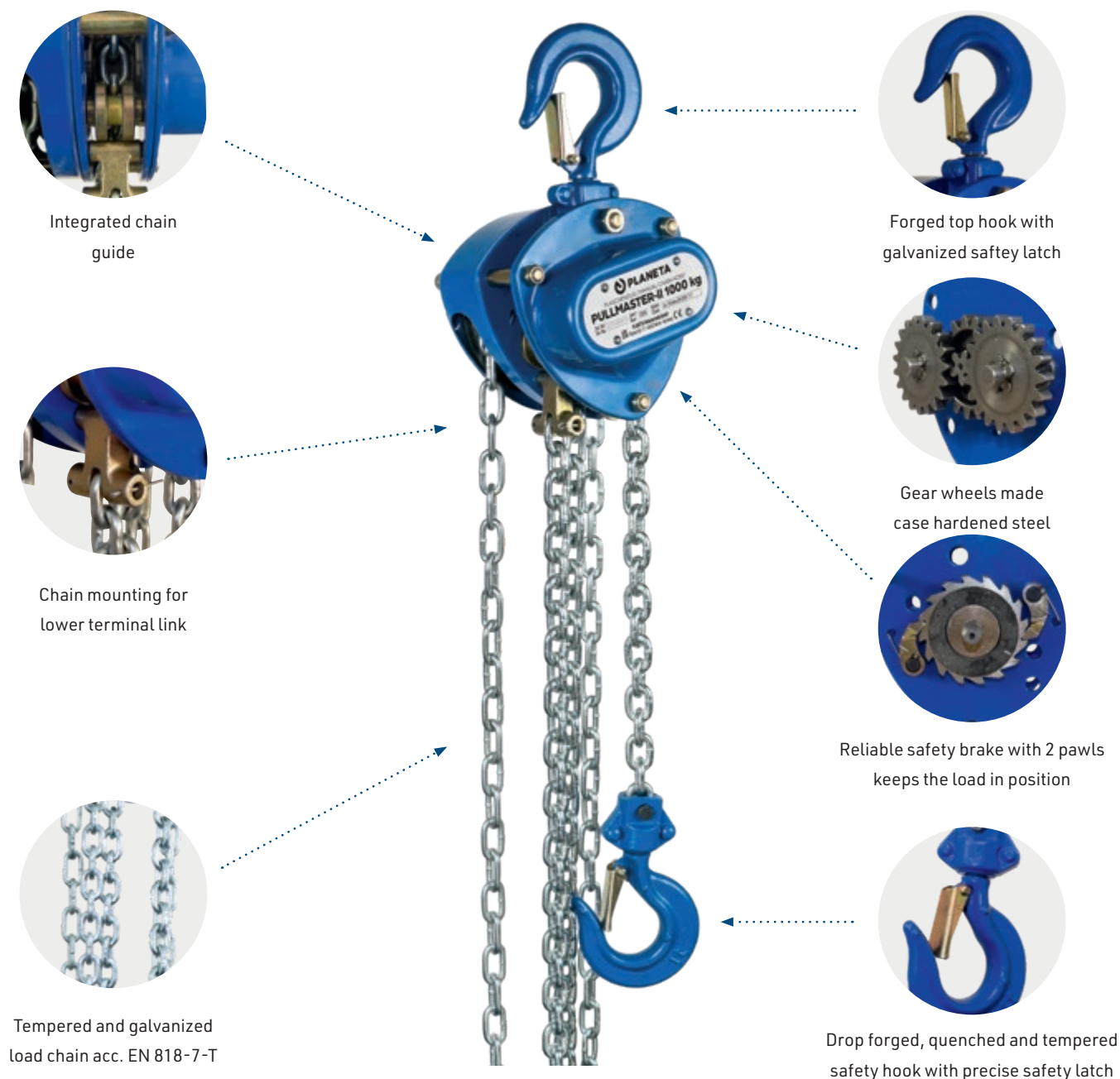

TYPE	PULLMASTER-II ...	0.5	1	1.5	2	3	5	10
Capacity	kg	500	1,000	1,500	2,000	3,000	5,000	10,000
Standard lift	m	3	3	3	3	3	3	3
Min. headroom (A)	mm	285	332	410	455	530	620	737
Hand chain force	daN	19	24	33	24	33	32	32
Hand chain operation length	m	2.5	2.5	2.5	2.5	2.5	2.5	2.5
Meters hand chain to pull to lift 1 m	m	25.5	41.5	44.8	82.9	89.6	154.9	309.7
Number of chain falls		1	1	1	2	2	2	4
Chain size	mm	5 × 15	6 × 18	8 × 24	6 × 18	8 × 24	10 × 30	10 × 30
C (Dimensions)	mm	120	147	181	147	181	224	373
B	mm	116	136	147	136	147	177	177
D	mm	28	32	38	40	45	50	64
Weight with standard lift	kg	7.5	11.5	15.8	16	22	37	68
Weight for 1 m additional lifting height*	kg	1.3	1.6	2.2	2.4	3.6	5.2	9.6
PULLMASTER-II ... with 3 m lift	Order No.	G10530	G10531	G10538	G10532	G10533	G10534	G10535
PULLMASTER-II ... with 6 m lift	Order No.	G10530-6	G10531-6	G10538-6	G10532-6	G10533-6	G10534-6	G10535-6
PULLMASTER-II ... with 10 m lift	Order No.	G10530-10	G10531-10	G10538-10	G10532-10	G10533-10	G10534-10	G10535-10
Additional 1 m lift	Order No.	G10241	G10242	G10243	G10244	G10536	G10246	G10537
RFID-Chip incl. mounting	Order No.	G10600	G10600	G10600	G10600	G10600	G10600	G10600

*1 m operating length and 1 m lift