

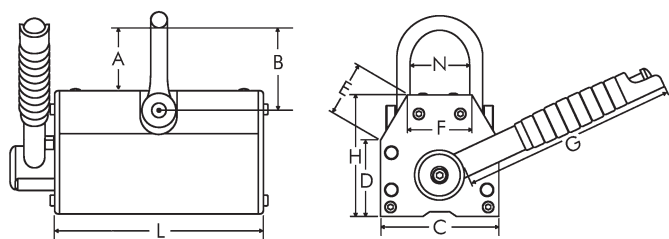

PML-3

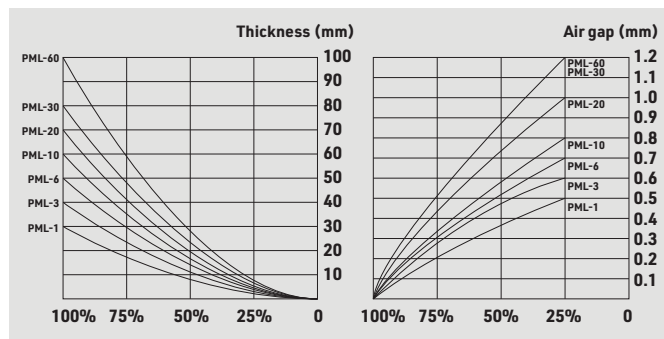

Safety coefficient
3,5



PERMAMENT MAGNET LIFTER | PML

Ideal for integrating into machine tools, steel structures, cutting torch systems, shipyards, foundries and steel works for moving injection moulding tools and punching tools and for general requirements in modern industrial companies.

Special features:

- Easy to handle
- Absolute reliability
- Robust design
- Extremely safe
- Competitively priced
- Small external dimensions
- Low weight
- High power
- Total operational safety

Custom-made products for vertical transportation of metal sheets on request!

Activate and deactivate the PML magnet with a single operating movement



MAGNETISATION

DEMAGNETISATION

Simply reversing the lever activates the magnet on the magnetic base. A safety device locks the lever in the MAG phase in order to prevent any unwanted demagnetisation (DEMAG).

TYPE	Capacity kg	Dimensions in mm										Flat material			Round material			Weight kg	Order No.
		A	B	C	D	E	F	G	H	L	N	max. load kg	min. thickness mm	max. length mm	max. load kg	min./max. diameter mm	max. length mm		
PML-1	100	42	145	72	44	28	28	116	76	94	31	100	15	1.500	45	10/50	1.000	3	F00060
PML-3	300	59	180	94	59	39	44	142	106	169	46	300	25	2.000	180	10/100	1.750	11	F00061
PML-6	600	87	230	115	70	44	56	178	115	218	58	600	30	2.250	270	15/125	2.000	25	F00062
PML-10	1.000	110	280	145	100	68	88	237	147	270	95	1.000	40	2.500	450	25/150	2.500	42	F00063
PML-20	2.000	150	450	160	135	98	115	397	165	340	117	2.000	55	3.000	900	35/200	3.000	70	F00064